

SELF LOCKING NUTS - NYLON INSERT

MS21044, AN365 HEX, REGULAR HEIGHT

MATERIAL - CARBON STEEL
300 SERIES CRES STL
FINISH - CAD TYPE II PER QQ-P-416
PASSIVATE PER QQ-P-35

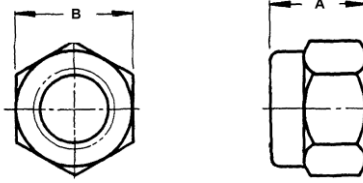

STEEL



CRES

| MS21044 | | | | | |
|--------------|-------------|-------------|-----------|-------------|-----------------|
| STEEL DASH # | CRES DASH # | THREAD SIZE | A DIM | B DIM | TENSILE LBS/MIN |
| N04 | C04 | 4-40 | .133-.157 | .243-.251 | 750 |
| N06 | C06 | 6-32 | .160-.188 | .305-.313 | 1130 |
| N08 | C08 | 8-32 | .219-.281 | .336-.345 | 1720 |
| N3 | C3 | 10-32 | .208-.281 | .367-.376 | 2460 |
| N4 | C4 | 1/4-28 | .240-.360 | .430-.439 | 4580 |
| N5 | C5 | 5/16-24 | .271-.360 | .492-.502 | 7390 |
| N6 | C6 | 3/8-24 | .318-.469 | .553-.564 | 11450 |
| N7 | C7 | 7/16-20 | .435-.469 | .679-.690 | 15450 |
| N8 | C8 | 1/2-20 | .575-.610 | .741-.752 | 21110 |
| N9 | - | 9/16-18 | .623-.704 | .865-.877 | 26810 |
| N10 | - | 5/8-18 | .732-.766 | .928-.940 | 34130 |
| N12 | - | 3/4-16 | .855-.891 | 1.052-1.064 | 50020 |
| AN365 | | | | | |
| 1024A | - | 10-24 | .208-.281 | .367-.376 | 2010 |
| 420A | - | 1/4-20 | .240-.360 | .430-.439 | 2760 |
| 720A | - | 7/16-20 | .435-.469 | .615-.627 | 15450 |

MS21083, AN364 HEX, THIN

MATERIAL - CARBON STEEL
300 SERIES CRES STL
FINISH - CAD TYPE II PER QQ-P-416
PASSIVATE PER QQ-P-35

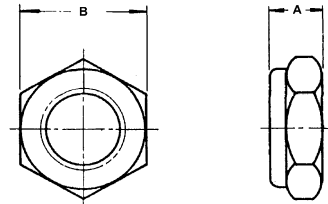

STEEL



CRES

| STEEL DASH # | CRES DASH # | THREAD SIZE | A DIM | B DIM | TENSILE LBS/MIN |
|--------------|-------------|-------------|-----------|-------------|-----------------|
| N04 | C04 | 4-40 | .094-.125 | .243-.251 | 350 |
| N06 | C06 | 6-32 | .110-.141 | .305-.313 | 530 |
| N08 | C08 | 8-32 | .157-.188 | .336-.345 | 840 |
| N3 | C3 | 10-32 | .157-.188 | .367-.376 | 1230 |
| N4 | C4 | 1/4-28 | .188-.219 | .430-.439 | 2290 |
| N5 | C5 | 5/16-24 | .235-.266 | .492-.502 | 3690 |
| N6 | C6 | 3/8-24 | .251-.282 | .553-.564 | 5680 |
| N7 | C7 | 7/16-20 | .298-.328 | .679-.690 | 7680 |
| N8 | C8 | 1/2-20 | .298-.328 | .741-.752 | 10440 |
| N9 | - | 9/16-18 | .344-.375 | .865-.877 | 13280 |
| N10 | - | 5/8-18 | .376-.407 | .928-.940 | 16880 |
| N12 | - | 3/4-16 | .391-.422 | 1.052-1.064 | 24680 |
| AN364 | | | | | |
| 720A | - | 7/16-20 | .298-.328 | .615-.627 | 7680 |