

## NUTS

### MS35649 - MS35650

#### HEX MACHINE SCREW

MATERIAL - CARBON STEEL PER FF-N-836  
 CRES. 300 SERIES PER FED-STD 66  
 BRASS, ALLOY 462,464 OR 360 PER FF-N-836

FINISH - STEEL - CAD PER AMSQQ-P-416 TYPE II, CLASS 2  
 CRES - PASSIVATE PER AMS2700  
 BRASS - BLACK OXIDE PER MIL-C-13924  
 OR TIN PER ASTM B 545

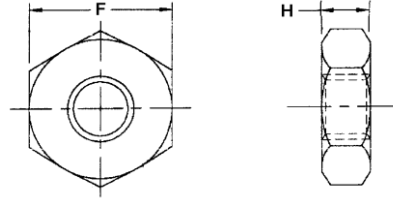

STEEL



CRES



BRASS - BL.OX.



BRASS - TIN PLT.

MS35649						
STEEL CAD PLT	CRES PASSIVATE	BRASS BL.OX.	BRASS TIN PLT	THREAD	F MAX	H MAX
DASH #	DASH #	DASH #	DASH #			
222	224	-	-	2-56	0.187	0.066
242	244	245B	245T	4-40	0.250	0.098
262	264	265B	265T	6-32	0.312	0.114
282	284	286B	286T	8-32	0.344	0.130
202	204	205B	-	10-24	0.375	0.130
252	2254	-	-	1/4-20	0.437	0.193
2312	-	-	-	5/16-18	0.562	0.225
2382	-	-	-	3/8-16	0.625	0.257
MS35650						
202	204	205B	-	10-32	0.375	0.130
252	2254	-	-	1/4-28	0.437	0.193
2312	-	-	-	5/16-24	0.562	0.225
2382	-	-	-	3/8-24	0.625	0.257

### NAS509

#### DRILLED, JAM

MATERIAL - 4130 ALLOY STEEL PER MIL-S-6758  
 FINISH - CADMIUM PER QQ-P-416 TYPE II, CLASS 2  
 HEAT TREAT - 150,000 PSI PER MIL-H-6875  
 HARDNESS - C34-38

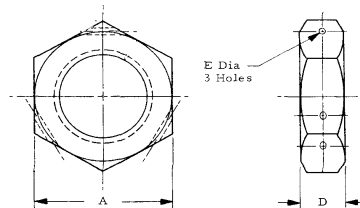

R/H THD DASH #	L/H THD DASH #	THREAD	A DIM	D DIM	E DIA
3	-	10-32	0.375	0.156	0.035
4	L4	1/4-28	0.438	0.188	0.046
5	L5	5/16-24	0.500	0.219	
6	L6	3/8-24	0.563	0.250	
7	L7	7/16-20	0.625	0.281	
8	L8	1/2-20	0.750	0.313	