

## SOCKET CAP SCREWS - ALLOY

### MS16997 / MS16998 SOCKET HEAD CAP SCREW

MATERIAL - ALLOY STEEL PER FF-S-86  
FINISH - CAD TYPE II, CLASS 2 PER AMS-QQ-P-416  
HEAT TREAT: 160 KSI

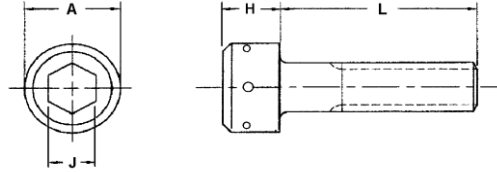

UNDRILLED

THREAD	MS16997			MS16998	
	4-40	6-32	8-32	10-32	1/4-28
A	0.183	0.226	0.270	0.312	0.375
H	0.109	0.138	0.164	0.190	0.250
J	0.094	0.109	0.141	0.156	0.188
MIN BREAKING STRENGTH (LBS)	920	1400	2170	3310	5680
LENGTH (L)	DASH#	DASH#	DASH#	DASH#	DASH#
0.250	9	18	-	-	-
0.375	10	19	31	26	40
0.500	11	20	32	27	41
0.625	12	21	33	28	42
0.750	13	22	34	29	43
0.875	-	23	35	30	44
1.000	-	24	36	31	45
1.250	-	-	37	32	46
1.500	-	-	38	33	47

### MS24677 / MS24678 SOCKET HEAD CAP SCREW

MATERIAL - ALLOY STEEL PER FF-S-86  
FINISH - CAD TYPE II, CLASS 2 PER AMS-QQ-P-416  
HEAT TREAT: 180 KSI



DRILLED

THREAD	MS24677			MS24678	
	4-40	6-32	8-32	10-32	1/4-28
A	0.183	0.226	0.270	0.312	0.375
H	0.109	0.138	0.164	0.190	0.250
J	0.094	0.109	0.141	0.156	0.188
DRILLED HOLE	0.033	0.033	0.044	0.044	0.044
MIN BREAKING STRENGTH (LBS)	1090	1640	2520	3600	6550
LENGTH	DASH#	DASH#	DASH#	DASH#	DASH#
0.250	1	6	-	-	-
0.375	2	7	14	9	19
0.500	3	8	15	10	20
0.625	-	9	16	11	21
0.750	-	-	17	12	22
0.875	-	-	18	13	23
1.000	-	-	19	14	24
1.250	-	-	20	15	-
1.500	-	-	21	16	-